



Declaration by FC as an Operator.
All timber arising from the Forestry England estate
represents a negligible risk under The Timber and
Timber Products and FLEGT (EU Exit) Regulations 2018.

1. Location

A3 Scale: 1:5,000

Forest District:	South England	Contract Type:	Eng. - Service - Estate Maintenance - Other
Contract Name:	HLS - Godshill & Woodgreen RTS Fencing	Prepared By:	Jayne Albery
Contract No:	HLS/S/21/0015	Date Prepared:	07/06/2022
Framework/ Service Contract:		Contract Manager:	Jayne Albery
Extent Name:	Location - Godshill Castle Hill	Contract Status:	Open

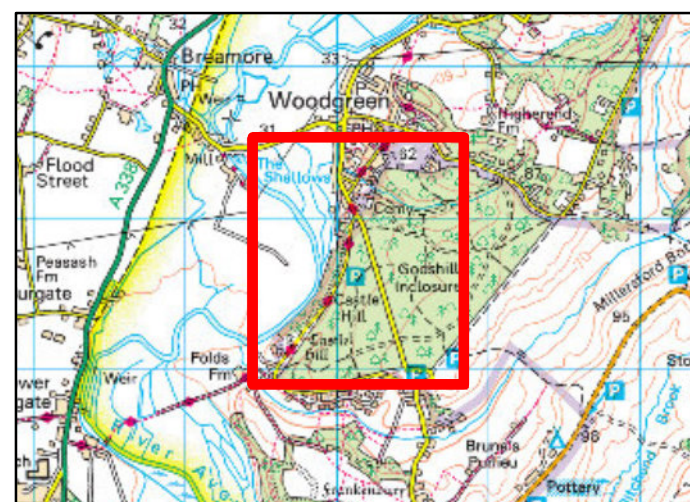

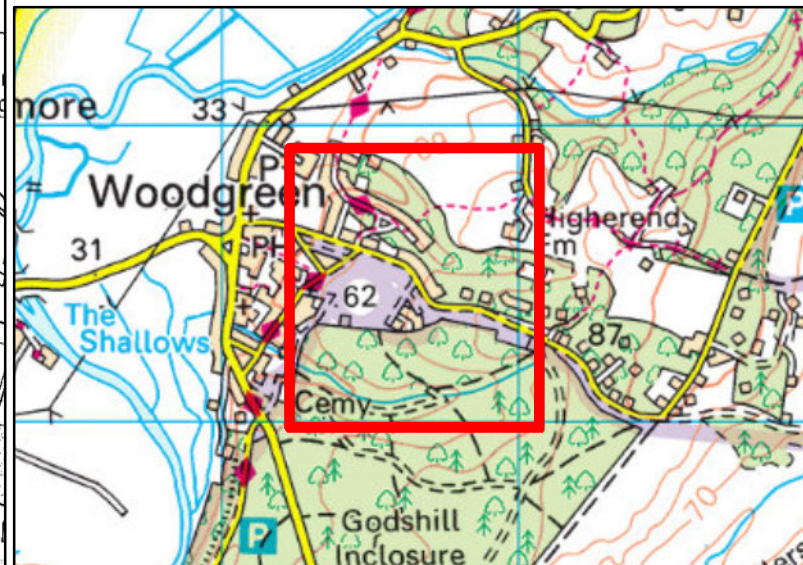
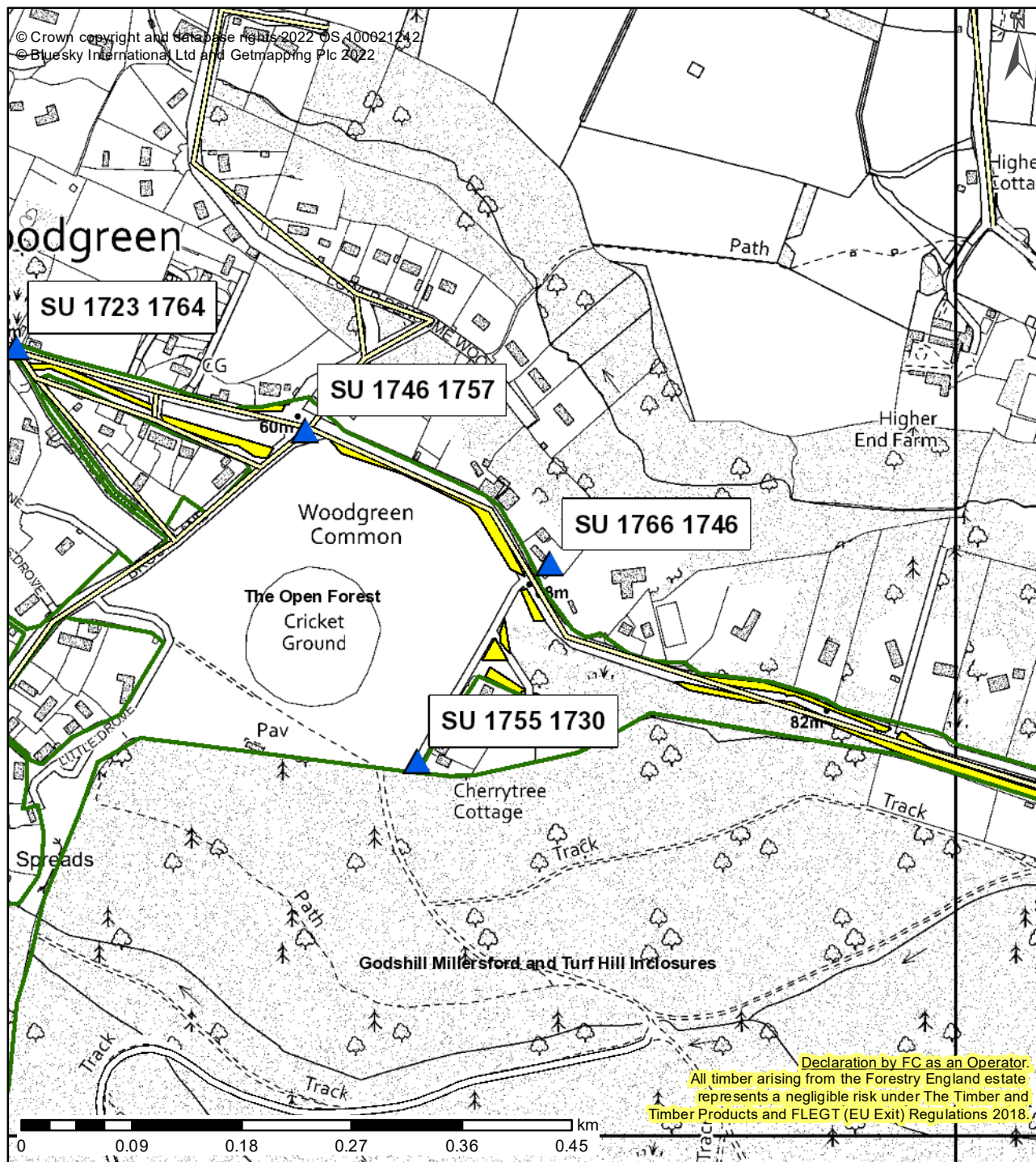

COLOUR MAPS MUST NOT BE PHOTOCOPIED IN BLACK & WHITE
ONLY VALID WITH ACCOMPANYING LEGEND PAGE

1. Location

A4 Scale:
1:5,000

Contract Type:	Eng. - Service - Estate Maintenance - Other
Forest District:	South England
Contract Name:	HLS - Godshill & Woodgreen RTS Fencing
Contract No:	HLS/S/21/0015
Framework/ Service Contract:	
Extent Name:	Location - Woodgreen
Prepared By:	Jayne Albery
Date Prepared:	07/06/2022
Contract Manager:	Jayne Albery
Contract Status:	Open

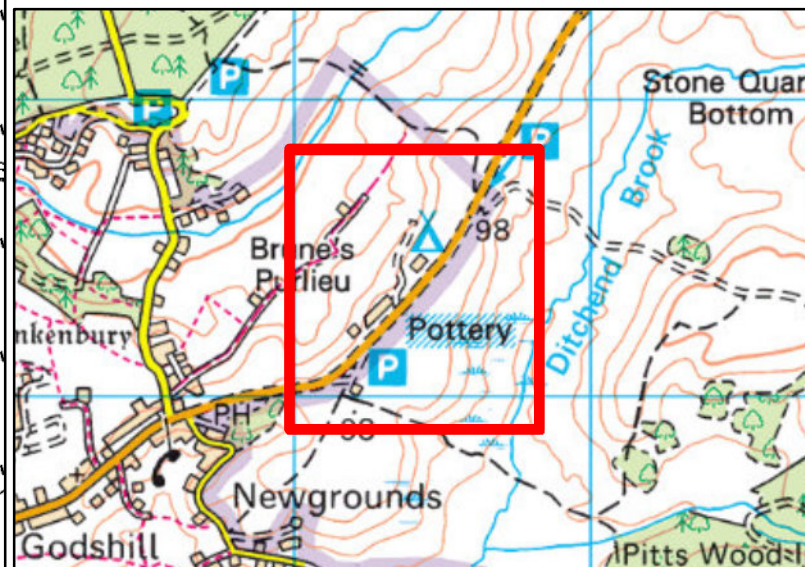
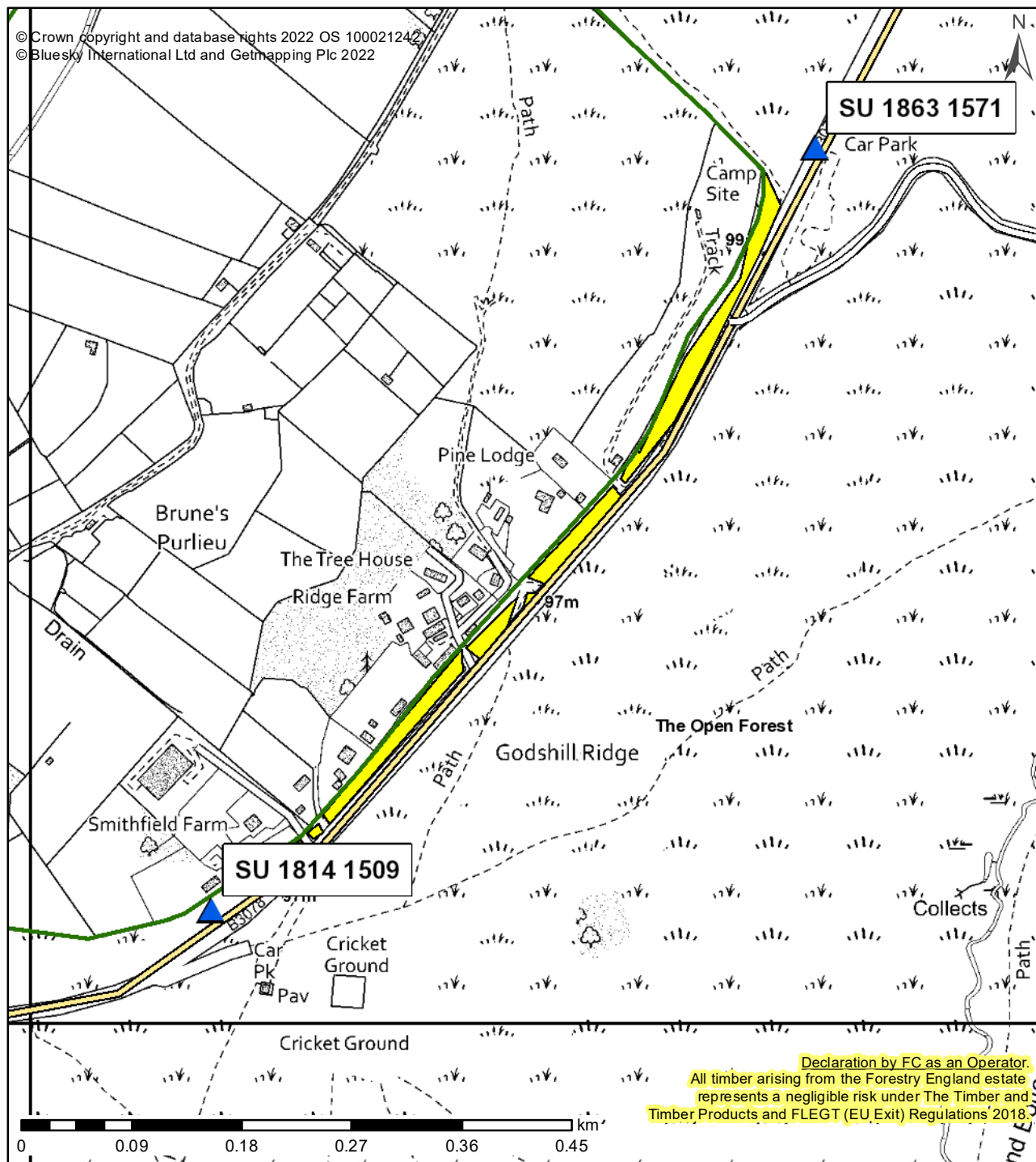

COLOUR MAPS MUST NOT BE PHOTOCOPIED IN BLACK & WHITE
ONLY VALID WITH ACCOMPANYING LEGEND PAGE

1. Location

A4 Scale:
1:5,000

Contract Type: Eng. - Service - Estate Maintenance - Other

Forest District: South England

Contract Name: HLS - Godshill & Woodgreen RTS Fencing

Contract No: HLS/S/21/0015

Framework/
Service Contract:

Extent Name: Location Godshill - Roger Penny Way

Prepared By: Jayne Albery

Date Prepared: 07/06/2022

Contract Manager: Jayne Albery

Contract Status: Open

Declaration by FC as an Operator

All timber arising from the Forestry England estate
represents a negligible risk under The Timber and
Timber Products and FLEGT (EU Exit) Regulations 2018.

1. Location

HLS - Godshill & Woodgreen RTS Fencing
HLS/S/21/0015

Access Points

 Access Points

Forest Roads

 Forest Roads

Minor Roads (GB)

 Minor Roads (GB)

Secondary Roads (GB)

 Secondary Roads (GB)

Blocks

 Blocks

Contract Areas

 Contract Areas

1. Location

HLS - Godshill & Woodgreen RTS Fencing
HLS/S/21/0015

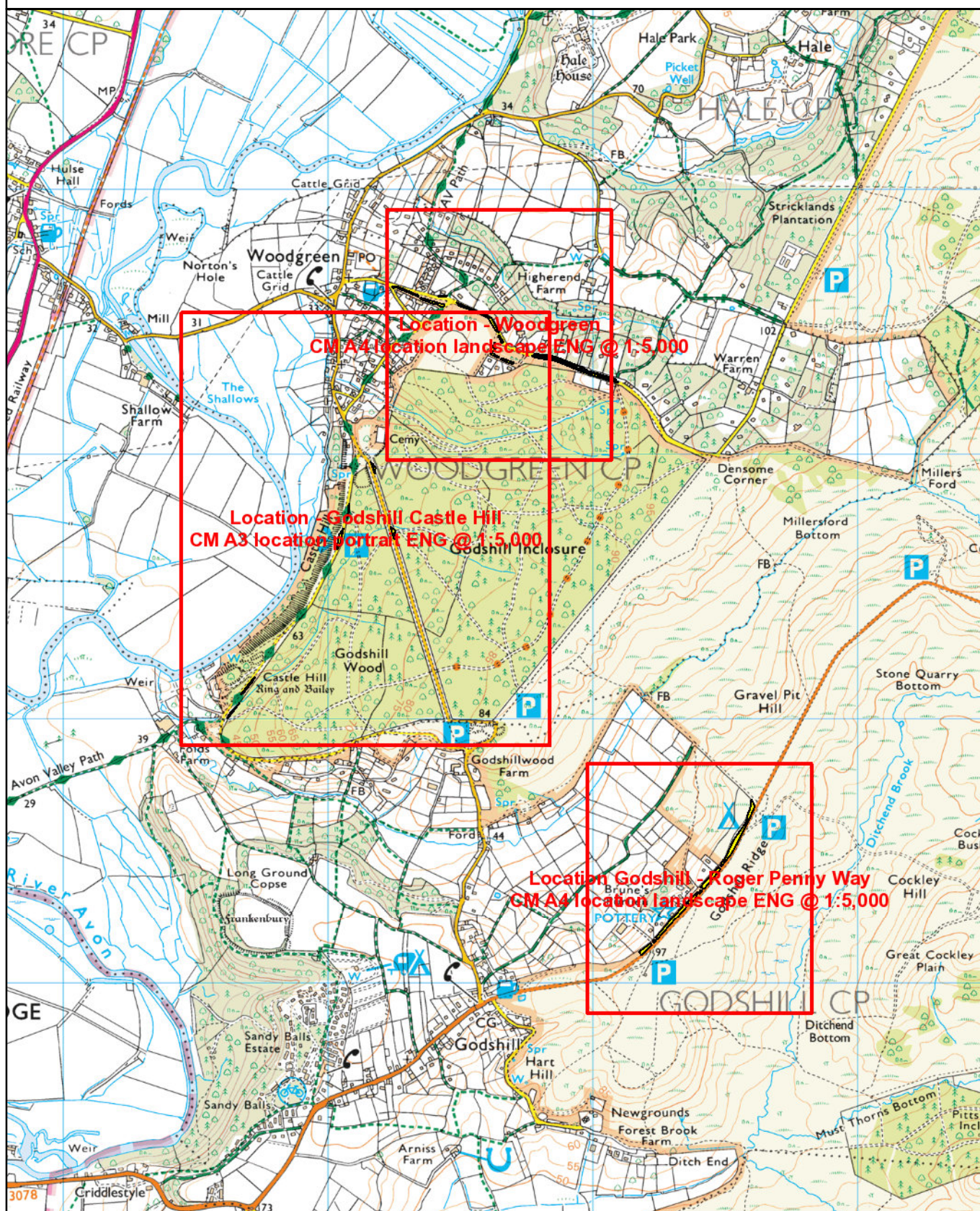

Contract Areas

 Contract Areas